

CHIPSEN

공 차	
0,000	
0,00	± 0,05
0,0	± 0,10
0,	±
ANGLE (각도)	±1°

모델명	
DC-1-1	

단위	
비율	
A0	

mm	
1:1	

문서번호	
작성일자	
수정일자	
재료	

2021-12-22	
------------	--

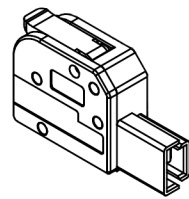

옆면으로 조립 확장 가능

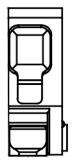
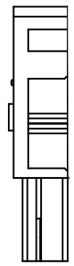
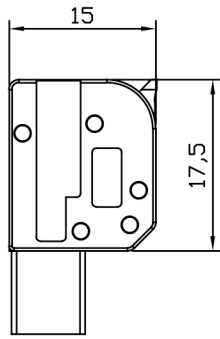
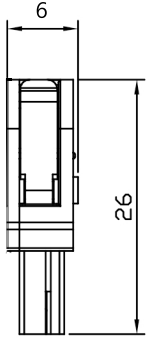
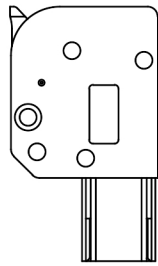
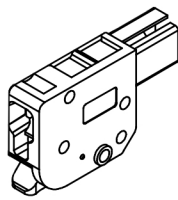
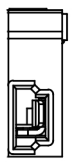

모델명	DC-1-1
제품명	전선커넥터
전선타피	12mm / 0.39in
온도범위	-20°C -- 105°C
홀 위치	X+N 위치 (간격5,5)
제품 소재	난연성 나일론,PC
접속단자	황동
체결부	스테인리스 스틸

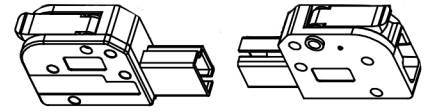

동일한 홀을 통한 결합 및 분리

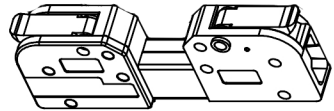

심사:

심의:

작성: